

Necco Street and Melcher Street Public Realm Improvements

Necco Street and Melcher Street
Public Realm Improvements
Overall Site Plan

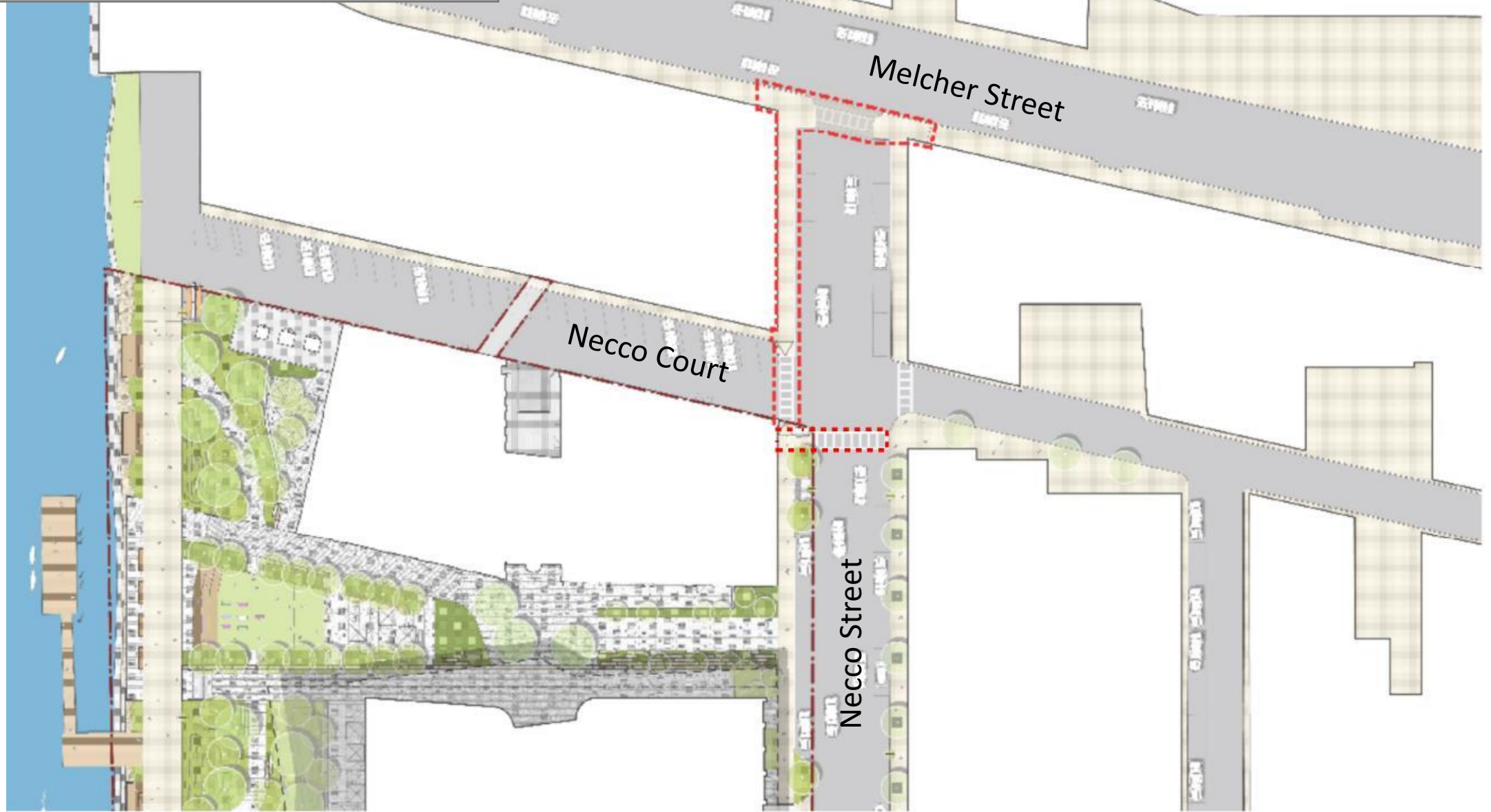

Necco Street and Melcher Street
Public Realm Improvements
Before & After

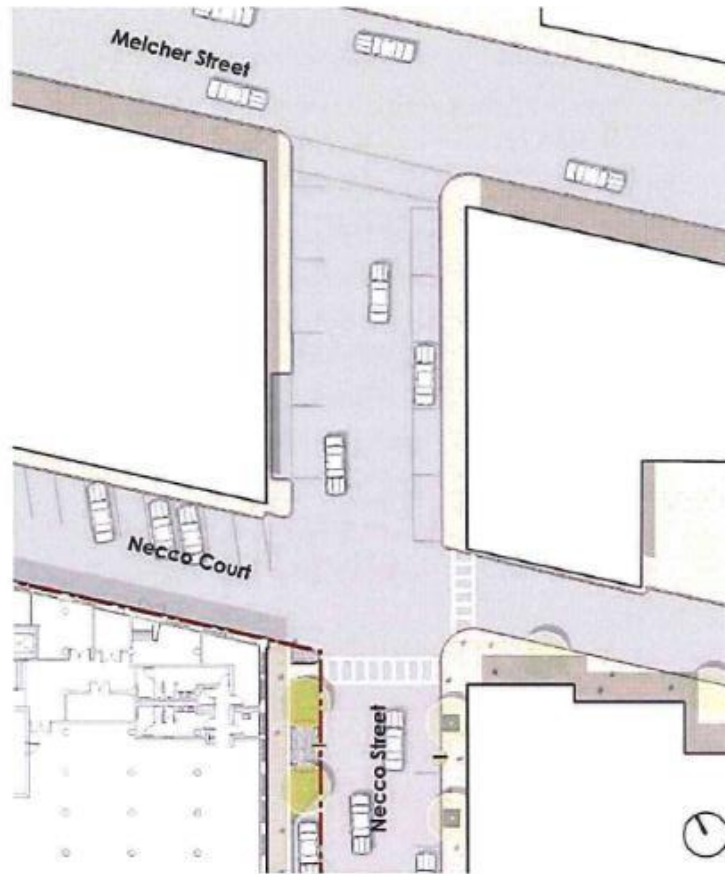

BEFORE

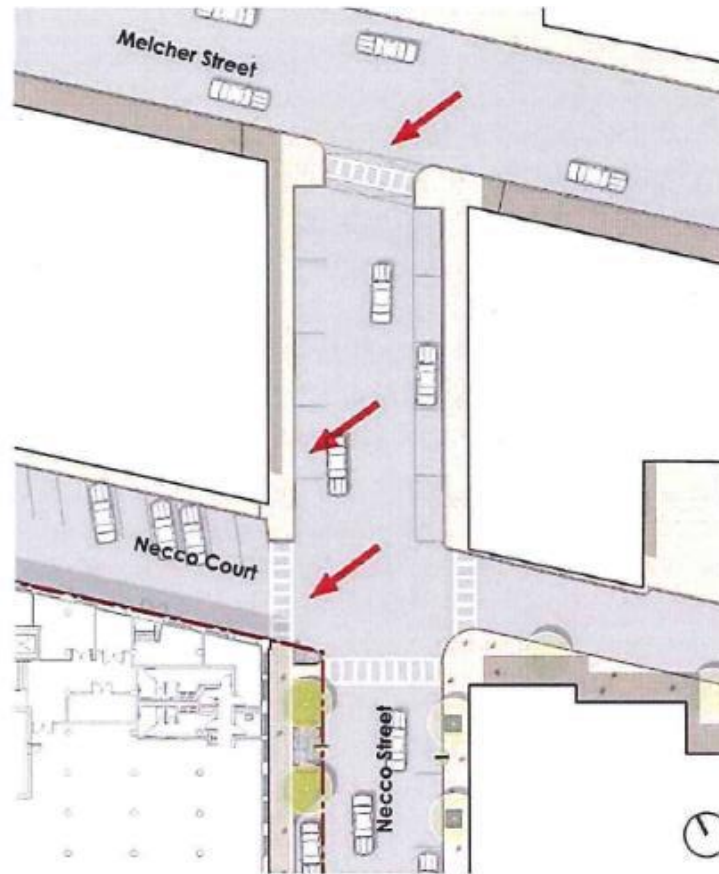

AFTER

Necco Street and Melcher Street Public Realm Improvements Construction Plan

A. The work includes one (1) raised crosswalk on Melcher Street, a public way, and two (2) new ramps.

B. One (1) raised crosswalk on the west side of Necco Street at Necco Court, private ways, and one (1) new ramp.

C. One (1) conventional crosswalk on Necco Street connecting Necco Court east.

★ The work also includes sidewalk repair/replacement on the west side of Necco Street between Melcher Street and Necco Court.

All improvements to be barrier free. This work will complete the accessible route to the waterfront from Summer Street.

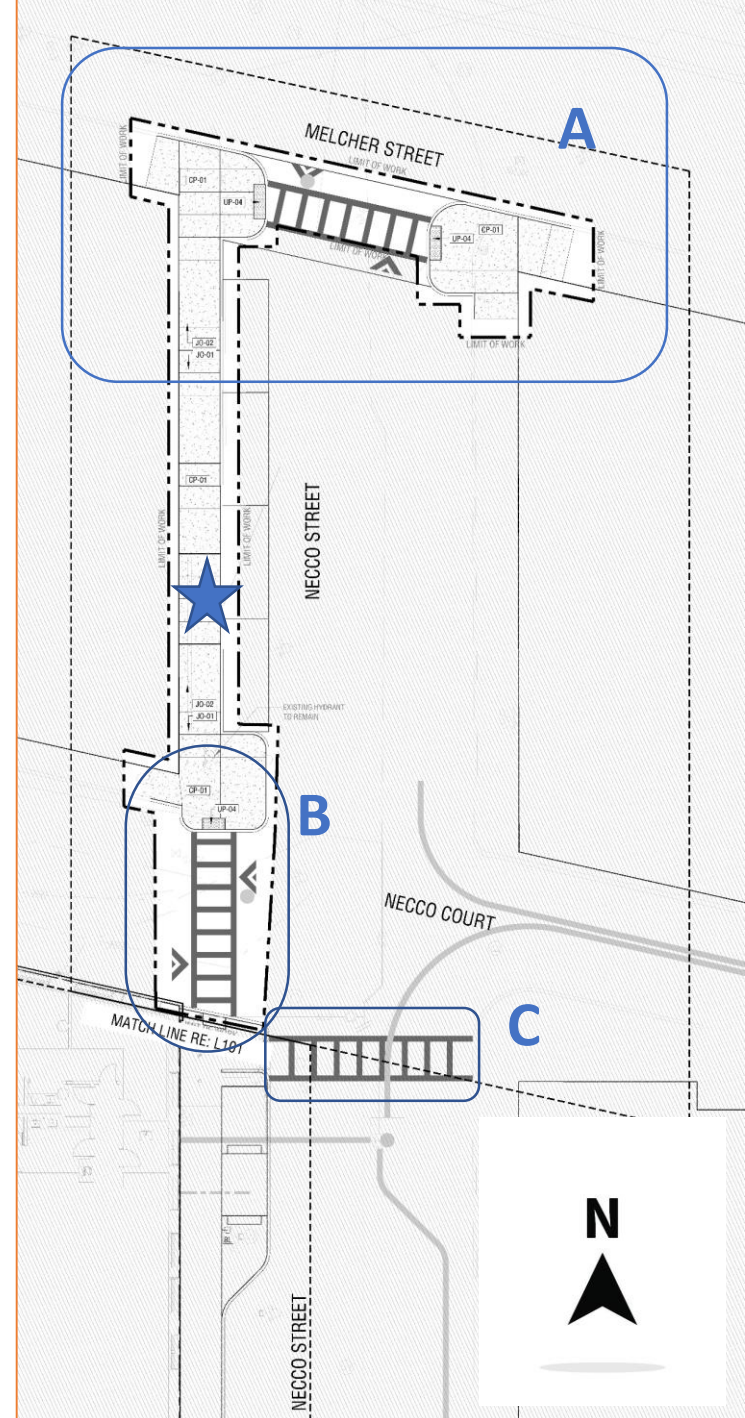

Necco Street and Melcher Street
Public Realm Improvements
Existing Conditions
Area A

Northwest corner of
Necco St. and Melcher St.
(looking north)



Dashed red line indicates
area of improvement

Necco Street and Melcher Street
Public Realm Improvements
Existing Conditions
Area A

Southeast corner of Necco St.
and Melcher St. (looking east)

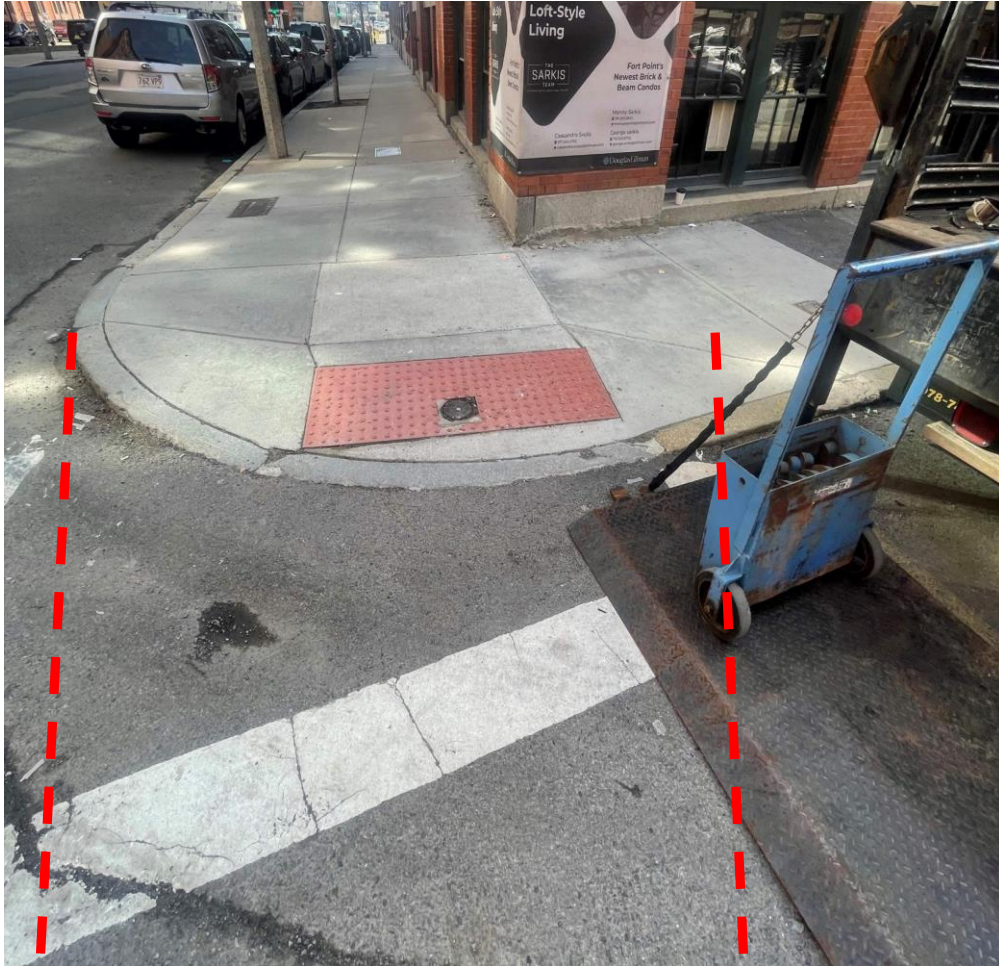

Dashed red line indicates
area for improvement

Necco Street and Melcher Street
Public Realm Improvements
Existing Conditions
Area B

Northwest corner of Necco St.
and Necco Ct. (looking south)

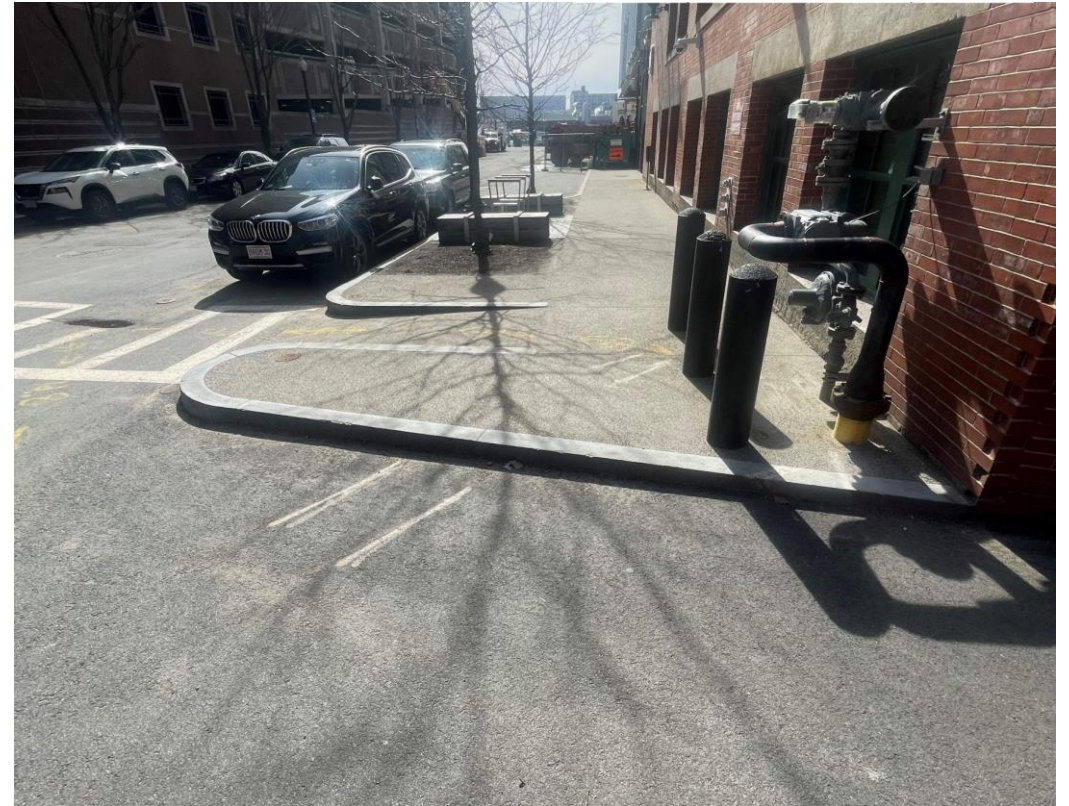

Dashed red line indicates future
raised crosswalk

Necco Street and Melcher Street
Public Realm Improvements
Existing Conditions
Area C

Northwest corner of
Necco St. and Necco Ct.
(looking east)

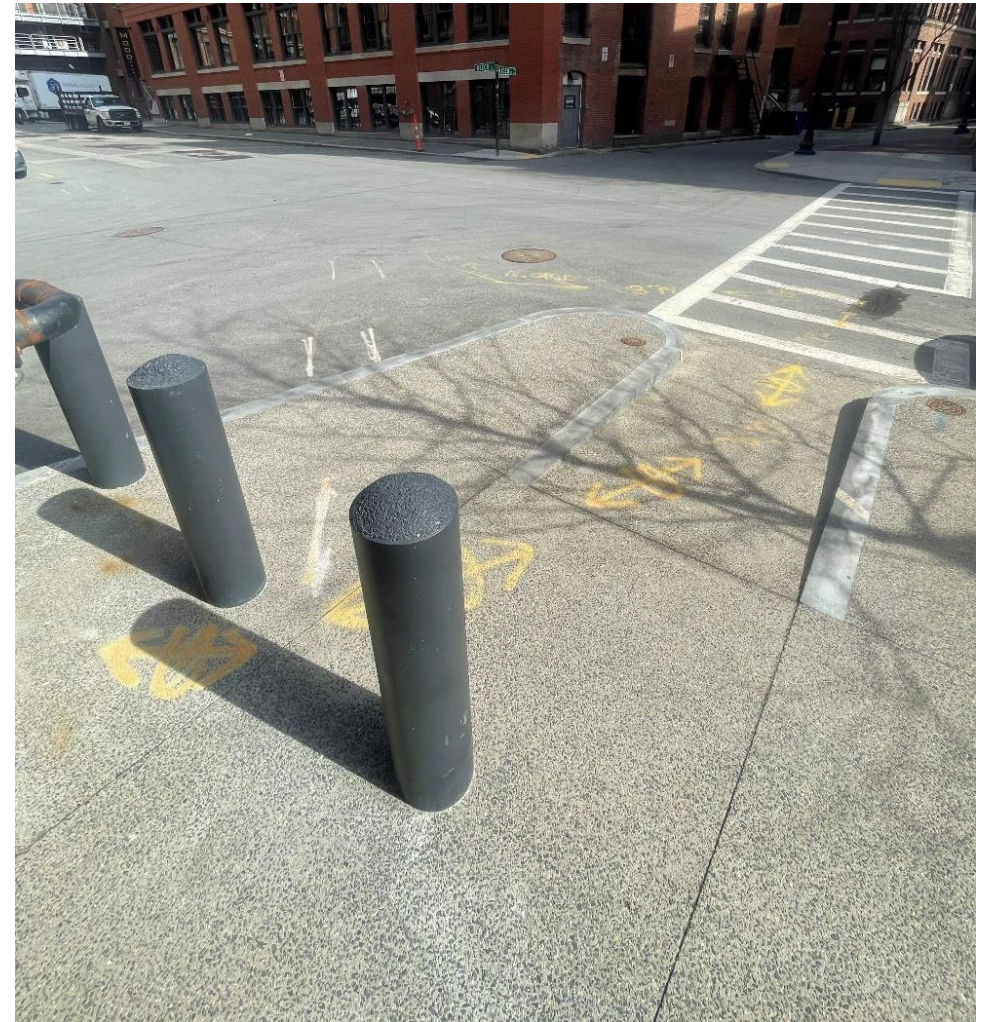

Dashed red line indicates
area for improvement

Necco Street and Melcher Street
Public Realm Improvements
Existing Conditions
Star Area

Northwest sidewalk of Necco St.
looking toward Melcher St.

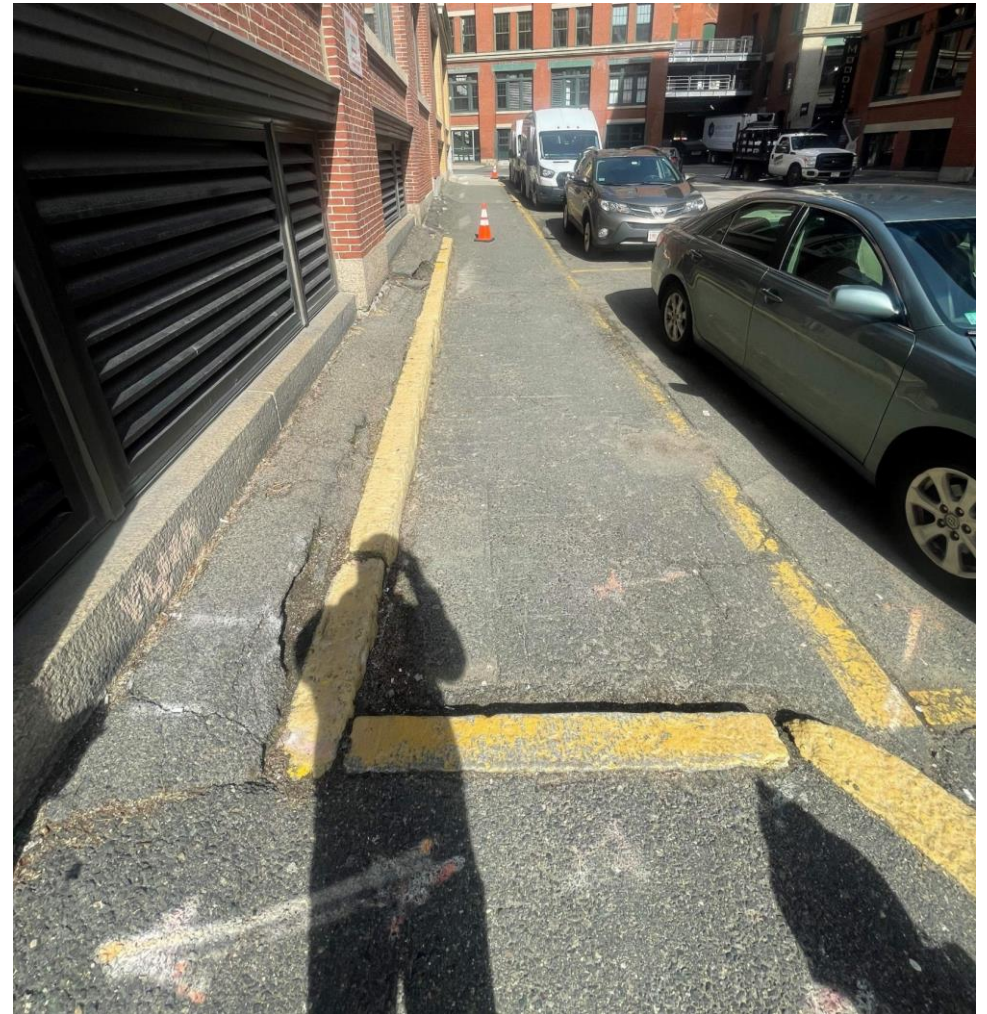

Dashed red line indicates
area for improvement

Necco Street and Melcher Street Public Realm Improvements **Materials**

Materials to match existing
concrete and vertical granite curb.
The ramps will be Neenah Foundry
2"x2" cast iron warning plate in
natural color.



Example raised Crosswalk



Example concrete sidewalk and
vertical granite curb



Example Foundry warning plate in natural